



BELLEFONTAINE  
CEMETERY

LAKESIDE COLUMBARIUM



BEAUTY | DIGNITY | SERVICE



## What is a Columbarium?

For thousands of years civilizations have built resting grounds—cemeteries—as permanent places to inter and remember their loved ones. In addition to offering traditional ground burial, many cemeteries have a columbarium, which is a building or structure dedicated to holding remains of those who have chosen cremation. Urns holding cremated remains are placed in niches within the columbarium.

## Cremation Options at Bellefontaine

In addition to offering traditional ground interment of cremated remains, Bellefontaine has two columbaria. The open-air Lakeside Columbarium, shown on the cover, is nestled between two lakes and along our brook. Its inner courtyard has benches and a fountain for resting and contemplation. Paths wind through the area for strolling and enjoyment of the landscape.

Bellefontaine's historic Hotchkiss Chapel, situated on the river bluffs, has an indoor columbarium with 665 niches. A separate brochure describes this lovely building.

## Lakeside Columbarium Overview

- 395 niches and five benches
- Niche measurements: 12 x 12 x 12 inches. Urn size 11 7/8th inches or less
- Niche cost: \$4,000
- Inscription: six lines of text, up to twenty characters per line
- Benches: \$30,000. Benches hold up to twenty urns
- Second right of inurnment: \$1,200

For more information please call: 314-381-0750.



FOUNTAIN INSIDE COLUMBARIUM



OUTER RING REFLECTING POOL



NICHES IN COLUMBARIUM

## Lakeside Columbarium Aerial Map

The map below corresponds to the photo of the columbarium on the cover. Niches are set into circular walls surrounding the courtyard and fountain. Walls are lettered from A to K. For specific niche selection or more information, please visit our office or contact our Customer Relations staff at 314-381-0750.

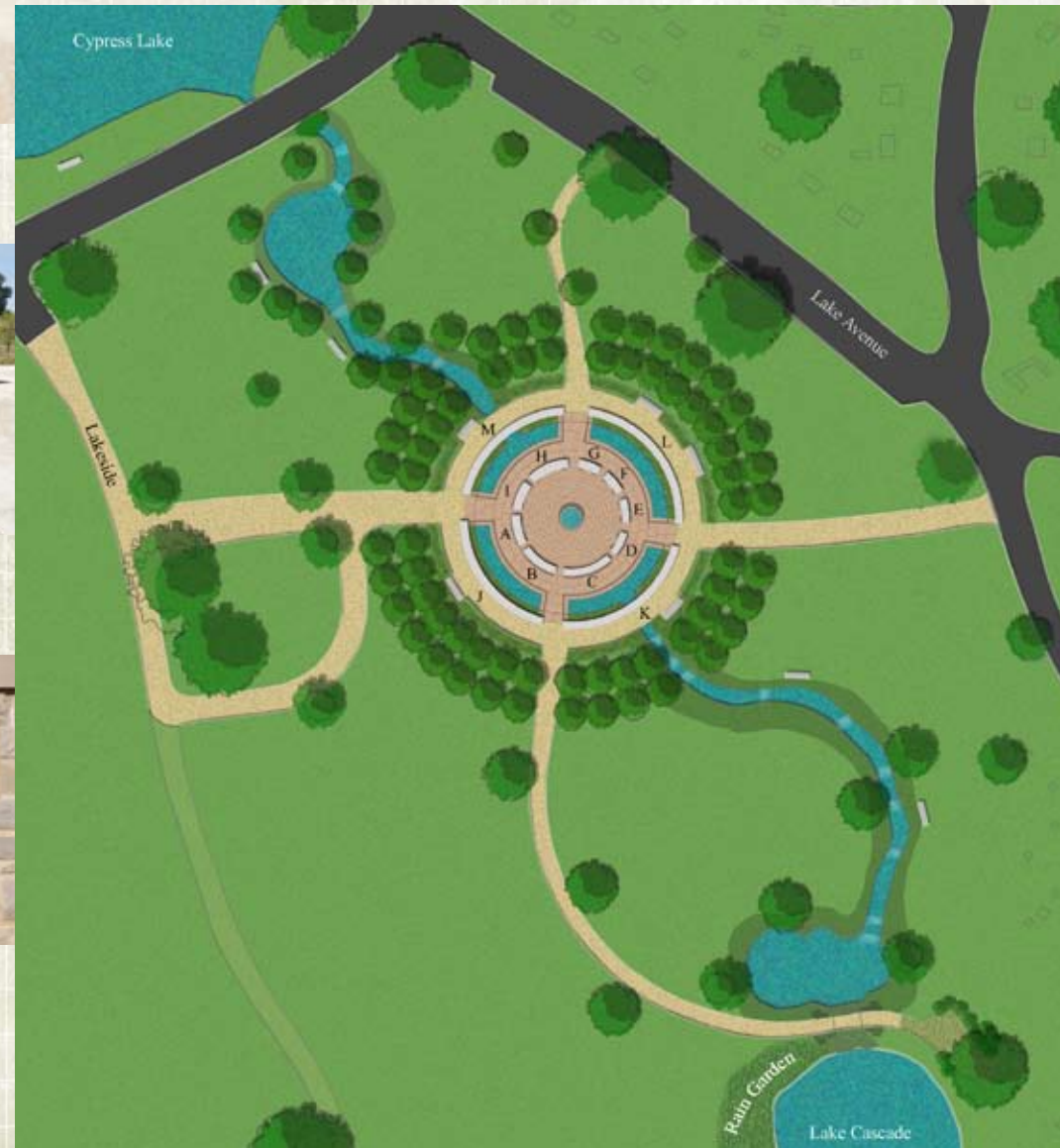

## Memorials and Events

Both the Lakeside Columbarium and Hotchkiss Chapel are available for memorial services or as a gathering place before or after an inurnment. We are happy to assist in planning, including arranging for caterers, florists, musicians and other service providers. They are also available for other events including concerts, weddings, private dinners or group meetings.



## Directions & Hours

**Exit 245B** from I-70 either direction.

To get to the columbarium enter the cemetery via the Main Gate on West Florissant Avenue. Make a right at Fountain, a right on Evergreen and a right at Lakeside Drive.

Visiting hours: 8am-5pm daily. Business hours: 8am-4:30pm Monday-Friday or by appointment.



## BELLEFONTAINE CEMETERY

4947 West Florissant Ave. | St. Louis, MO 63115

Ph: 314-381-0750

[www.bellefontainecemetery.org](http://www.bellefontainecemetery.org)